

Slewing Drive Performance Parameters		
Tilting Moment	135.6 kN.m	100x10 <sup>3</sup> lbf.ft
Holding Torque	72.3 kN.m	53.3x10 <sup>3</sup> lbf.ft
Static Axial Rating	970 kN	218.3x10 <sup>3</sup> lbf
Static Radial Rating	390 kN	87.8x10 <sup>3</sup> lbf
Dynamic Axial Rating	235 kN	52.9x10 <sup>3</sup> lbf
Dynamic Radial Rating	205 kN	46.1x10 <sup>3</sup> lbf

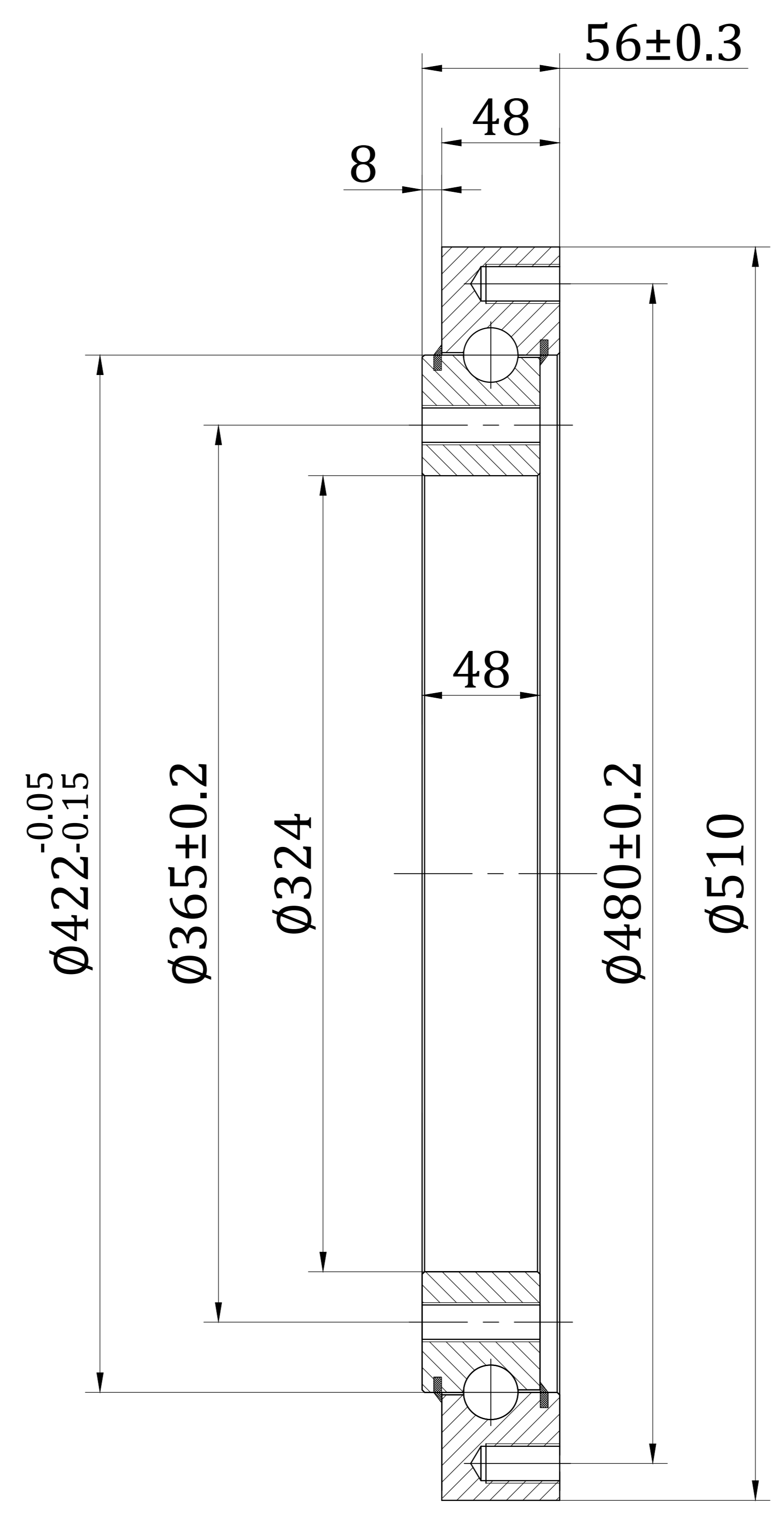
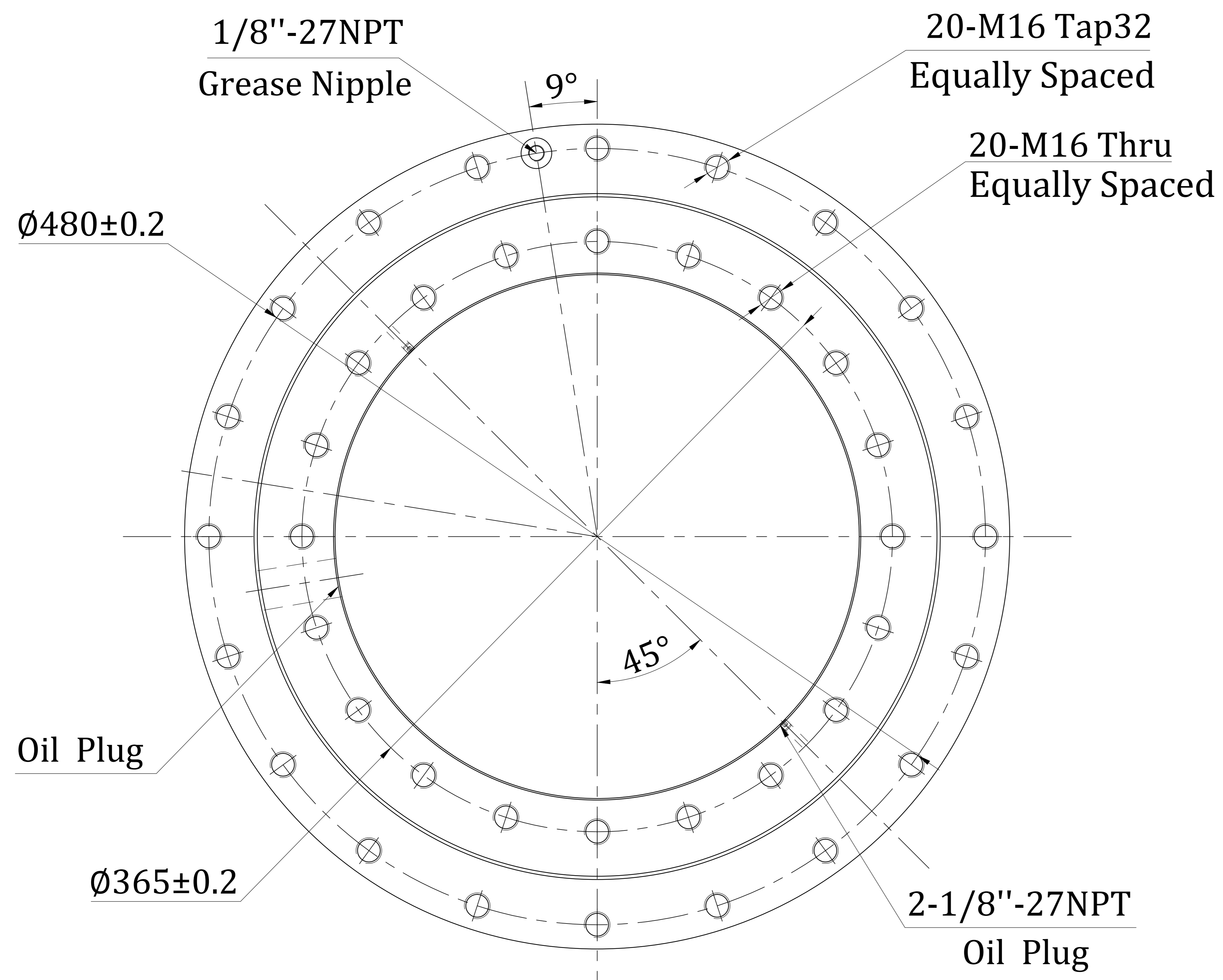
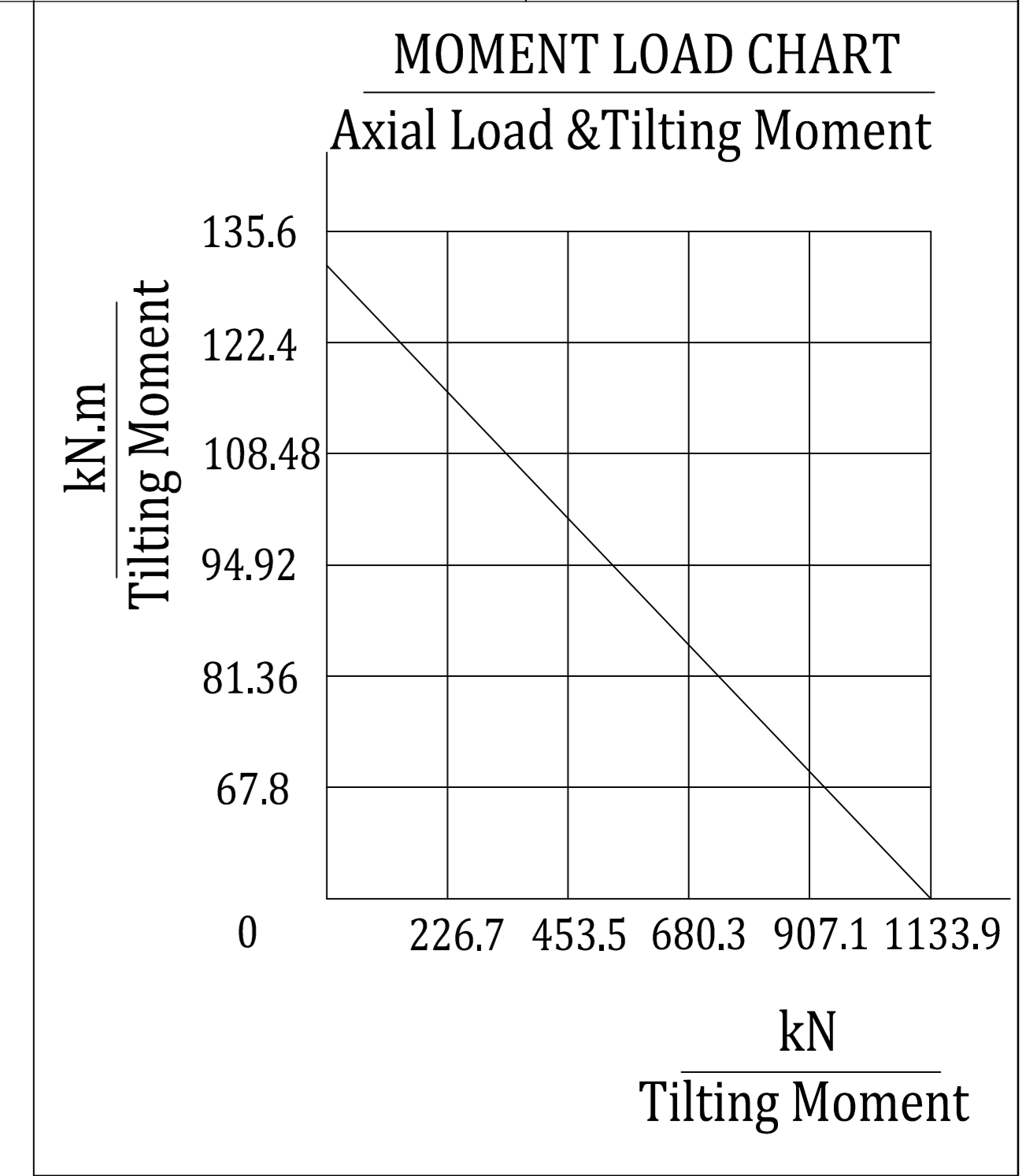

### Technical Requirement

1. The material is 50Mn, the modulated hardness of outer ring is HB235-285.
2. The quenching hardness of raceway surface is HRC-56-62, and the effective hardened layer depth is not less than 2.5mm.
3. Undeclared chamfer C1.
4. Surface galvanizing treatment.

REV	DATE	REVISER	REVISER				
DESIGNED BY	2021/2/17	Li Ming	<b>www.coresundrive.com</b> Coresun Drive Equipment Changzhou Co., Ltd.				
CHECKED BY	2021/2/17	Rui Wang					
APPROVED BY	2021/2/17	Shane Zhang					
<small>ALL PROPRIETARY RIGHTS IN THE SUBJECT MATTER HERE OF ARE RESERVED, AND NO PERMISSION IS GRANTED OR TO DISCLOSE REPRODUCE THIS PRINT IN WHOLE OR IN PART, ANY OF THE INFORMATION TO OTHERS.</small>			WEIGHT	SCALE	<h2>Slewing Ring</h2>		
<small>SYMBOLS ISO</small>			SIZE	A3			
			SHEET	1 / 1	SR-010-510 <table border="1" style="float: right; margin-left: 20px;"> <tr><td>REV</td><td>A</td></tr> </table>	REV	A
REV	A						